

INSTALLATION**Of your FRONT ACCESS POL LED BULB****WHAT IS INCLUDED IN THE KIT****TOOLS REQUIRED**

6mm Hex Tool

Flat Head Tool



Needle Nose Pliers

INSTALLATION INSTRUCTIONS

Figure 1

Figure 2

Figure 3

Figure 4

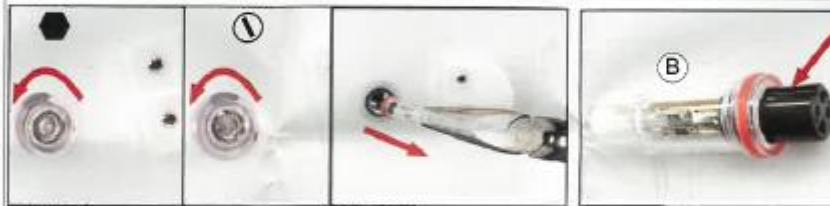

Figure 5

Figure 6

Figure 7

Figure 8

1. Locate the front accessible LED POL on the spa shell close to the pillow insert. Firmly insert either a 6mm hex tool or a flat head tool (depending on what the housing cap looks like). Turn counter clockwise until housing cap is removed. See (Figure 1&2).
2. Using needle nose pliers, grab and pull out the LED bulb and sleeve located inside the POL housing as shown in (Figure 3).
3. Insert the replacement LED bulb and sleeve (B) into the POL housing. Make sure you align the groove on the bottom part of the LED bulb connection to the connector located inside the POL housing. (Figure 4).
4. Check your POL housing and identify the type of housing as this step is critical for the correct installation of your POL kit. See (Figure 5 and 6).
5. If the front edge of your housing is flat as seen in (Figure 5), you will use the clear o-ring (C1) by placing it on the housing cap as seen in (Figure 7).
6. If your housing has a rib on the inner edge of the opening as seen in (Figure 6), you will use the white color o-ring (C2) by placing it on the front of the housing as seen in (Figure 8).
7. Install new housing cap (A) using a flat head tool. Turn clockwise until tight.

NOTE: DO NOT OVERTIGHTEN